

36 High Street, Brandon, Suffolk, IP27 0AQ
Tel: 01842 813466
brandon@chilternsestateagents.co.uk
www.shiresresidential.com

chilterns

Estate & Letting Agents



London Road, Brandon, Suffolk, IP27 0EL
Rent - £1,215 PCM Deposit - £1,401

A spacious mid terraced house located within close proximity to the centre of Brandon and its amenities. Property benefits from two reception rooms with kitchen/breakfast room, three bedrooms and a cellar.

AGENTS NOTE: Property images may have been digitally enhanced, edited, or virtually staged using artificial intelligence and may not accurately reflect the property's current presentation, condition, furnishings, or contents. Floorplans and measurements are provided for guidance only and should not be relied upon.

- MID TERRACED HOUSE
- 3 BEDROOMS
- BENEFITS FROM CELLAR
- FAMILY BATHROOM
- PARKING & REAR GARDEN
- CLOSE TO TOWN CENTRE
- GAS HEATING & ENERGY RATING - D
- APPROXIMATE SIZE - 1162 SQFT
- COUNCIL TAX BAND - C
- AVAILABLE NOW



Council Tax Band: C - EPC Rating: D 55

BASEMENT LEVEL
15.1 sq.m. (162 sq.ft.) approx.

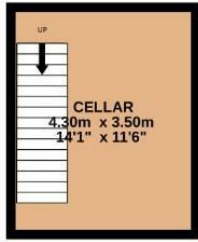

GROUND FLOOR
57.9 sq.m. (623 sq.ft.) approx.

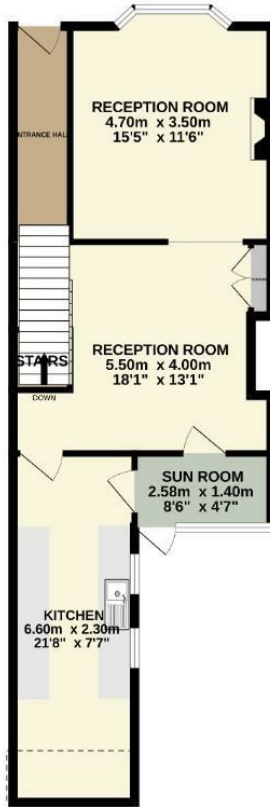

1ST FLOOR
43.6 sq.m. (469 sq.ft.) approx.



TOTAL FLOOR AREA: 116.5 sq.m. (1254 sq.ft.) approx.

Whilst every attempt has been made to ensure the accuracy of the floorplan contained here, measurements of doors, windows, rooms and any other items are approximate and no responsibility is taken for any error, omission or mis-statement. This plan is for illustrative purposes only and should be used as such by any prospective purchaser. The services, systems and appliances shown have not been tested and no guarantee as to their operability or efficiency can be given.
Made with Metropix ©2008.

